



Stirling, WA

4 Lyrrad Brace

4
BED

2
BATH

2
CAR

paragon
PROPERTY

LUCKY LYRRAD!!

HOME OPEN - Saturday 7th July 12:15-1:00pm!

Beautifully presented and surrounded by stunningly designed properties, this fabulous home is part of the exclusive Roselea Estate and has so much to offer, the perfect place for a family and ample space to grow. Featuring a fantastic open floor plan, multiple living areas, entertaining spots and quality fixtures throughout, this one is a must see!

Set on a full sized 475sqm block, this location is ideal. Find yourself within walking distance to Roselea Estate Lake and Macedonia Park, while also being close to Karrinyup Shopping Centre, Balcatta Growers Fresh, local primary and secondary schools, cafes and easy access to Mitchell Freeway taking you straight into Perth CBD.

\$895,000

Contact:

Nik Zounis

0418 913 456

Theo Kouroulis

0411 751 377

Type:

House

Land:

475m²

<http://paragon.staging02.harmonic.com.au>

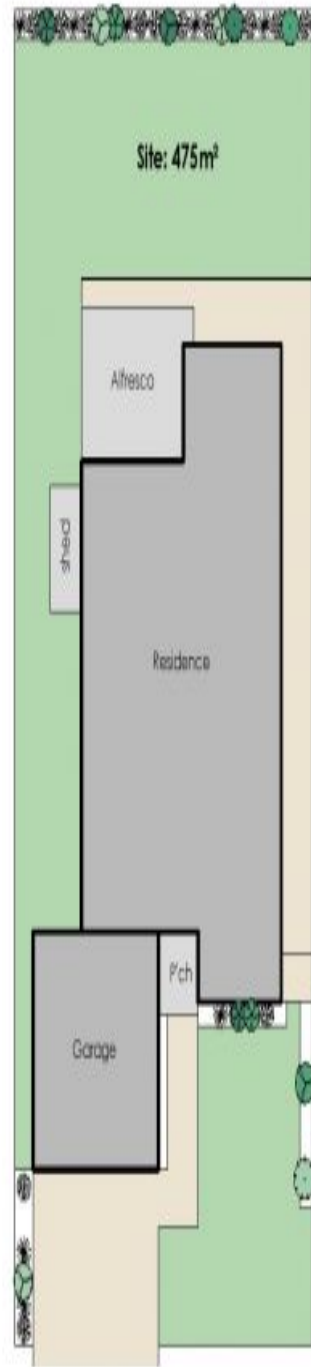
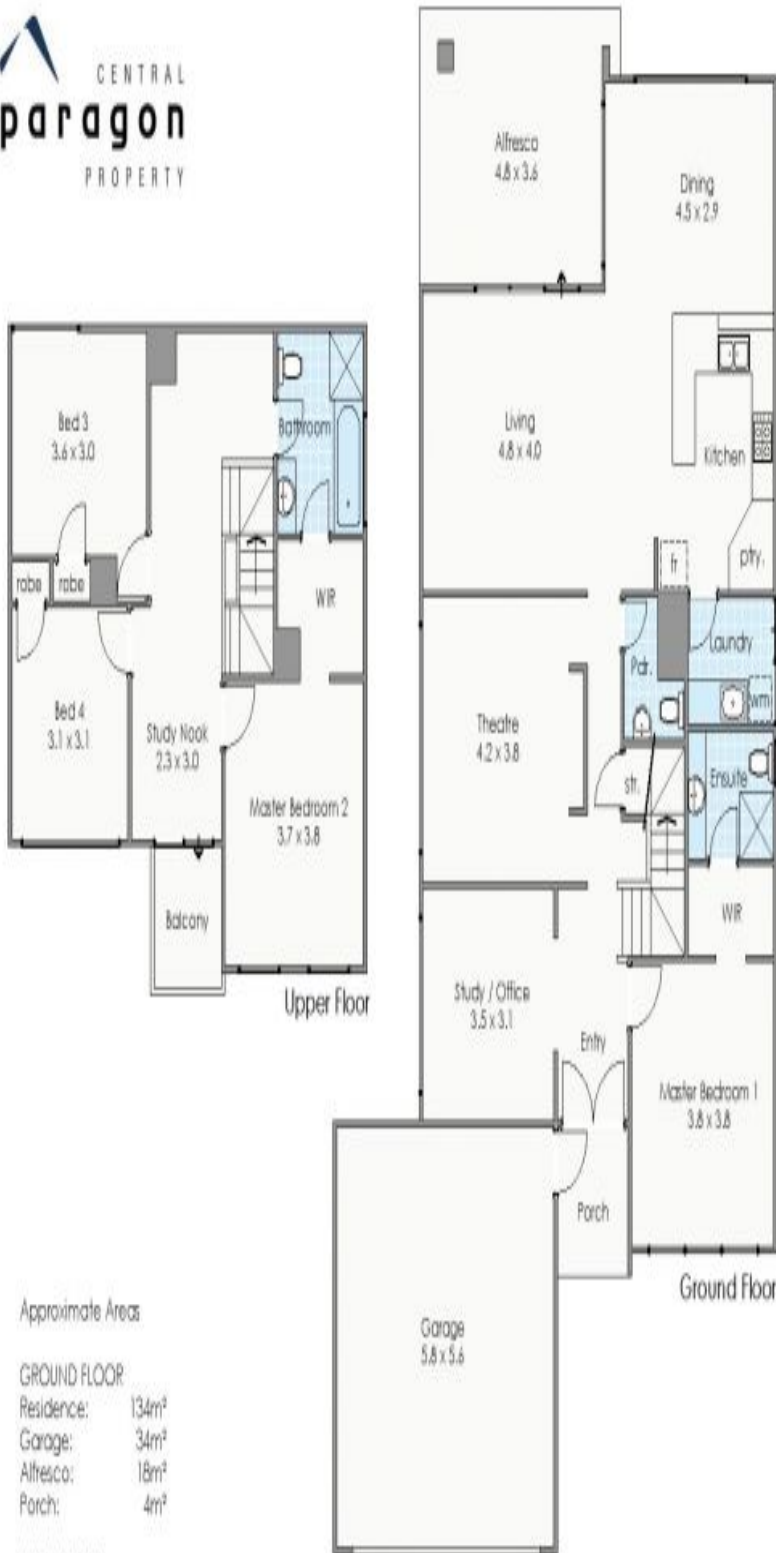

LYRRAD BRACE

Approximate Areas

GROUND FLOOR

Residence:	134m ²
Garage:	34m ²
Alfresco:	18m ²
Porch:	4m ²

UPPER FLOOR

Residence:	72m ²
Balcony:	4m ²
Total area:	266m²

All measurements are estimates
All dimensions are in metres,
Plans are for demonstration only.
www.crbcreative.com.au



4 Lyrrad Brace, Stirling

Plans shown are only indicative of layout. Dimensions are approximate.

Stirling, WA
4 Lyrrad Brace